

SOPHISTICATED UPDATE

A SHOWER ROOM IS GIVEN A LUXURIOUS OVERHAUL WITH SUMPTUOUS TEXTURES AND SULTRY SHADES OF GREY

WORDS *Helen Adams* STYLING *Wendy Bannister* PHOTOGRAPHY *Tony Owczarek*



Design tip

To evoke a hotel-bathroom feel, introduce unexpected elements such as sophisticated wall lamps and elegant artworks

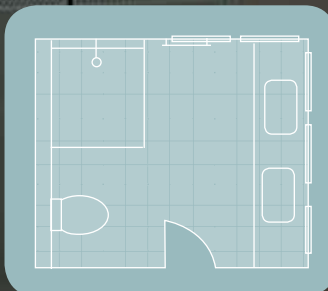

1



2



3

1+2 Vanity matters

When figuring out your budget, consider which area of your bathroom will have the most impact. The owners set aside a substantial part of theirs for the vanity unit, now a strong focal point. Long enough for two basins, the quartz stone benchtop sets the high-quality tone of the room and pairs beautifully with the veneer cabinetry. The grain of the veneer runs horizontally to match the unit's long bar handles and serves to accentuate its length, while power points are tucked away inside the cabinet so as not to interrupt the flow of the splashback. This eye-catching feature, clad in chunky, rustic-chic reflective mosaics, provides a textural link between the smoothness of the painted wall, above, and tactile benchtop.

3 Staying true

This smart shower room is unrecognisable from its original state, a significant achievement given that interior designer Renae Barrass stuck to the same simple yet functional layout, enabling the plumbing to stay in place. The elongated layout enables the users to make full use of the space without getting in each other's way, while the simplicity of the design allows the luxe finishes to really stand out, making the room a real style statement.

4 Gentle shades

Part of the appeal of this space is its elegant, understated colourway. The area receives an abundance of natural light, which helps to offset the dark charcoal paintwork. A wall painted in white balances the predominantly grey shades, while finishing touches in the shape of framed artwork and designer lighting completes the whole scheme.

4

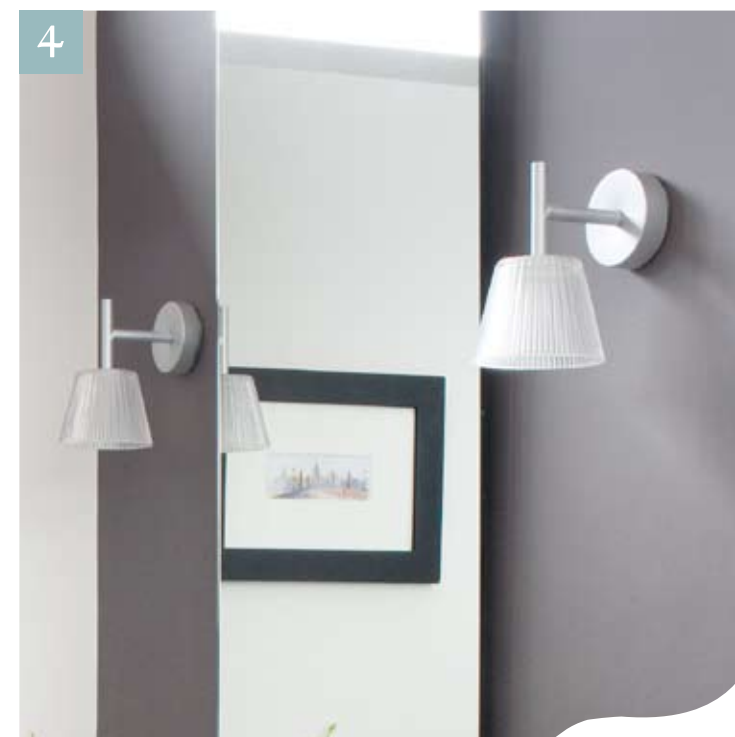

24

DESIGN FILE

Expect to pay: Around \$30,000, including installation.

Basins: Catalano 'C3', Rogerseller.

Lighting: Flos 'Romeo Babe' wall lights by Philippe Starck, Space.

Paint: Wash & Wear 101 Advanced low-sheen acrylic in Natural White and Cave Man, both Dulux.

Shower: For similar, try 'Designo' shower set, Hansa.

Tapware: Logic wall basin outlet, Rogerseller.

Tiles: Charcoal porcelain for wall and floor, Floor-tech. Casa Dolce

Casa mosaics in Lux Cemento as border tiles, Aeria Country Floors.

Toilet: Catalano 'C52', Rogerseller.

Vanity: Jaipur quartz in Vanilla, Stone Italiana. Cabinetry in Aniseed reconstructed wood veneer, Evener.

Contact: Renae Barrass of Austin Design Associates, (03) 9592 6411.

Stockists, page 160.